

OPERA

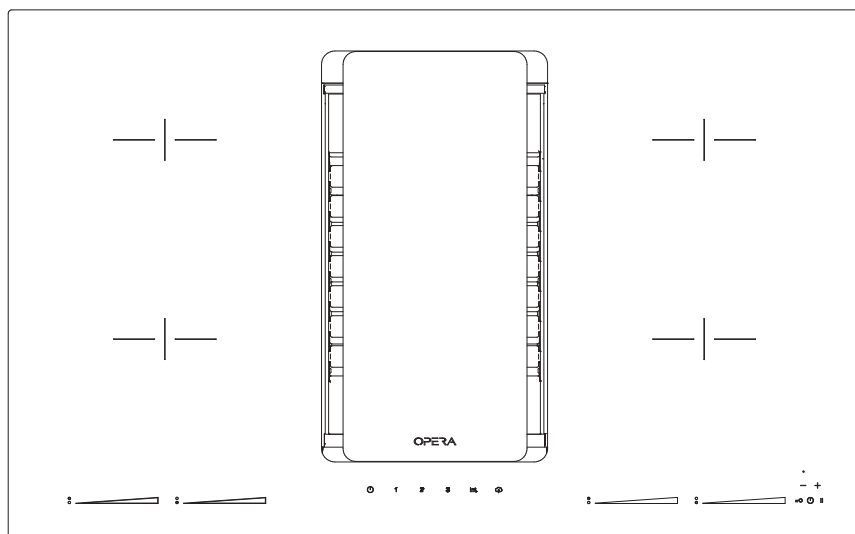

FONDA 800-830-900

User's manual - Hood

- DE** Bedienungsanleitung - Absaughaube
- NL** Gebruikershandleiding - Zuigkap
- EN** User's manual - Hood
- IT** Manuale d'uso - Cappa di aspirazione
- ES** Manual de usuario - Campana de succión
- FR** Manuel d'utilisation - Hotte aspirante

Dear customer,

Thank you for choosing a OPERA extractor hood.

Please carefully read the following information and explanations on the proper use of your new OPERA hood before using the appliance for the first time. Please also read our operating and installation instructions as well as the cleaning recommendations to ensure that you enjoy many years of service from your appliance.



The data contained in these operating instructions is used for descriptive purposes only. No statement regarding a particular quality or suitability for a specific application can be implied from the information provided. The information provided does not relieve the user of the responsibility to carry out their own assessments and checks. It should be noted that our products are subject to a natural process of ageing and wear.

All rights are reserved by Kosmo srl, also in the case of applications for industrial property rights. All rights of disposal, such as the right to create copies or circulation rights rest with us.

The title page shows a sample configuration. The product supplied may therefore differ from the illustration.

The operating instructions were originally drafted in English.

TABLE OF CONTENTS

	PAGE
WARNING NOTICE AND SYMBOLS :	24
PRELIMINARY REMARKS :	25
- Safety instructions :	25-27
GENERAL FUNCTIONAL DESCRIPTION :	
- Operating mode :	28
- Product description :	29-30
OPERATING INSTRUCTIONS :	
- Operation / ventilation :	31
- Replacing the filter :	32-36
- Cleaning the filter :	32-33
USER INFORMATION :	
- Optimum extraction :	37
- Risk of burning: do not place anything on the hot hob :	38
CLEANING AND CARE :	
- Cleaning :	39
- Care instructions :	39
- Faults / maintenance :	40
ENVIRONMENTAL INFORMATION :	
- Disposal :	41
- Environmental information :	41
- Technical data :	41

WARNING NOTICE AND SYMBOLS

Warnings in these operating instructions are placed in front of an instruction that may result in personal injury or property damage. Measures to avert a hazard must be observed.

SYMBOL	IMPORTANCE
	<p>Warning of a danger spot ! Indicates potentially dangerous situations. Failure to observe the warning notices may result in personal injury and/or damage to property.</p>
	<p>Warning of dangerous electric voltage! Indicates possible hazards due to electricity. Failure to observe the warnings may result in death, injury and/or property damage.</p>
	<p>Warning of hot surface ! Indicates possible hazards due to high surface temperatures. Failure to observe the warnings may result in personal injury and/or damage to property.</p>
	<p>Warning of hand injuries ! Indicates possible hazards due to moving and rotating parts. Non-observance of the warnings can result in personal injury.</p>
	<p>Warning of toxic substances ! Indicates possible dangers due to inhalation of toxic gases. Failure to observe the warnings may result in death or serious poisoning.</p>
	<p>Warning of flammable substances ! Indicates possible dangers due to fire hazard. Failure to observe the warnings may result in death, personal injury or property damage.</p>
	<p>Warning of cuts due to glass breakage ! Indicates possible hazards due to sharp edges. Failure to observe the warnings may result in cutting injuries and personal injury.</p>

PRELIMINARY REMARKS

Safety information

These operating and installation instructions contain important information that must be observed to ensure safe and reliable operation of the extractor hood. Please store them in a safe place for future reference. These operating instructions refer to several versions of the appliance. They may contain descriptions of certain features not found on your model. The extractor hood must not be used by persons (incl. children) with impaired physical or mental capabilities or persons who lack experience and/or knowledge of how to use it. Children must be supervised to ensure that they do not play with the appliance.

Intended use

The extractor hood may only be used to extract kitchen vapours above the cooking appliances in private households. Any other use will be deemed to be improper. Improper use of the hood may pose a danger to persons and objects. The extractor hood must not be used as a shelf to store objects such as bottles, spice jars or other loose objects.

Installation

The appliance may only be installed and connected by an authorised technician observing all relevant regulations of the electric utility companies and the applicable building regulations. During installation, observe the relevant instructions! Damaged appliances may not be put into operation. Defective parts must be replaced with genuine parts. Repairs should only be carried out by authorised technical staff.



Danger of intoxication!

If the extractor hood is operated in extraction mode at the same time as other room-air-dependent fire appliances (e.g. wood, gas, oil or coal-fired appliances) in the same room, lethal combustion gases may be directed back into the room due to the resulting negative pressure. For this reason, you must ensure a sufficient air supply at all times! The negative pressure in the room must not exceed 4 Pa (0.04mbar).

Please make sure that your extractor fan is fitted with an properly installed window contact (applies to exhaust air operation).



Fire hazard!

The extractor hood must never be operated without the grease filter and must always be used under supervision. Filters that are saturated with grease can pose a fire hazard! Keep the extractor hood under constant supervision when deep-frying! Remember to clean out the filters regularly. Flambéing under the extractor hood is not allowed! Gas appliances may only be used under the extractor hood with saucepans placed over them! If you are using more than three gas rings at the same time, operate the extractor hood at power level "2" or higher. This prevents the build-up of heat in the appliance.

Preparing for use

The extractor hood model complies with the relevant safety regulations for kitchen appliances in private households. The requirements regarding the installation location are described in the user documentation supplied with the appliance. If you have any doubts as to whether your intended installation location meets the requirements, please contact our service department. Damaged appliances may not be put into operation. Defective parts must be replaced with genuine spare parts or parts specified by Kosmo. Repairs should only be carried out by authorised technical staff.



Activated carbon filter

For activated carbon filters fitted in OPERA extractor hoods (C Version), please read the separate operating instructions provided!

Transport, unpacking, installation

Condensation may occur if the appliance is brought into the installation site from a cold environment. Please wait until the appliance has adjusted to the temperature and is completely dry before operating it. The acclimatization period depends on the temperature difference and the type and design of the appliance. However, it should be at least 12 hours.

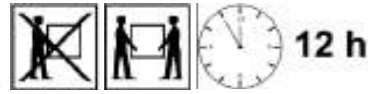

Connecting the power supply

Check that the rated voltage of the device corresponds to the local mains voltage. Incorrect setting will damage or destroy the device. The device may only be installed on the electrical mains by a trained electrician who is familiar with and carefully observes the local regulations and additional regulations of the local electrical supply companies. The protection against accidental contact of operationally insulated parts must be ensured after assembly. It must be possible to disconnect the device from the mains at all poles by means of disconnecting devices. When switched off, there must be a contact distance of 3 mm between the contacts. Suitable isolating devices are LS switches, fuses and contactors.

Attention! Make sure that the wires are inserted correctly and that the screws are tightened tightly. We are not responsible for incidents caused by incorrect connection, or missing or incorrect earth connection. Check before operation whether all cables and wires are faultless and undamaged. In particular, make sure that the cables have no kinks, have not been laid too short around corners and that there are no objects on the cables. Furthermore, make sure that all plug connections are tight. Faulty shielding or wiring endangers your health (electric shock) and can destroy other equipment. Devices with a mains plug are equipped with a safety-tested mains cable from the country of use and must only be connected to a properly earthed earth contact socket, otherwise there is a risk of electric shock. Make sure that the socket at the device or the earth contact socket of the house installation is freely accessible so that the mains cable can be disconnected from the socket in an emergency or during service or maintenance work. If the power supply cable of this appliance is damaged, it must be replaced by the manufacturer, its customer services or a similarly qualified person in order to avoid hazards.

The appliance must not be operated with an external timer or an external telecontrol system. The reliable and safe operation of the hob is only guaranteed if it is connected to the public electricity network.

The hob must not be connected to a stand-alone inverter that is used with an autonomous power supply, such as solar power. Otherwise a safety switch-off may occur when switching on the hob due to voltage spikes. The electronics may be damaged.

The electrical safety of the hob is only guaranteed when it is connected to an earth conductor system installed according to the regulations. This basic safety requirement must exist.



Danger of electric shock!

Do not clean the hood with a steam cleaner or water pressure cleaner. The hood must be disconnected from the power supply prior to cleaning.

***Children in the household***

Children under eight years of age must be kept away from the hob, unless they are continuously supervised.

Children over eight years of age must only operate the hob without supervision if they have been shown how to operate it safely. Children must be able to recognise and understand the possible hazards caused through incorrect operation. Children must not clean the hob without supervision. Supervise children who are close to the hob.

Never allow children to play with the hob. The hob becomes hot during operation and remains hot for some time after it is switched off. Keep children away from the hob until it has cooled down to avoid any risk of burning.

Risk of burning!

Do not store objects that may be of interest to children in storage areas above or behind the hob. Otherwise the children will be enticed to climb onto the appliance.

***Risk of burning and scalding!***

Turn pot and pan handles sideways over the working surface so that children cannot pull them off and burn themselves. Risk of suffocation! Children can wrap themselves in packaging material (e.g. foils) when playing or pull it over their head and suffocate. Keep packaging material away from children.

***Design***

From an aesthetic perspective, the extractor hood may differ from the drawings in these operating instructions. However, the operating instructions, maintenance, cleaning and installation procedures are always the same. The drawings and plans must be consulted in the case of customer-specific products.



GENERAL FUNCTIONAL DESCRIPTION

Operating mode

The Fonda recess ventilator from OPERA has 2 vapour openings, whereby the right or left one can be adapted manually to the respective cooking situation. The vapour openings are arranged centrally between two hot plates. The vapour opening consists of a safety glass panel with two extraction openings that can be removed easily for cleaning without a tool.

The Fonda has an innovative and sophisticated 3-stage filter system that is arranged under the vapour openings. This consists of a condensation filter, a stainless steel grease filter and optionally a fine dust / odour filter. The different filters can be easily removed from the top without a tool.

This filtration mainly removes condensation, dirt particles, grease particles as well as fine dust and odour particles from the cooking vapours. The cleaned air is extracted by means of a powerful fan motor arranged in the base of the cooking unit. The individual power levels are controlled via a touch panel that is arranged centrally.

The connection of the Fonda recess ventilator to the fan motor is generated by means of streamlined exhaust air ducts that are delivered in fitted lengths.

The model offers effective extraction with simple handling and is available in the “internal motor exhaust air”, “internal motor recirculating air” and “external motor” fan versions.

- 1 FONDA incl. hot plates and extraction unit
- 2 Naber ventilation duct
- 3 Fan motor
- 4 Connection cable for hot plates (~1.3 m long)
- 5 Power supply cable with plug (~1.5 m long)
- 6 Control box
- 7 Ventilation control panel
- 8 Hob control panel (see separate instructions)
- 9 Exhaust air vent
- 10 Control panel cable - fan motor
- 11 Safety glass, variably adjustable
- 16 Intake silencer (Circulating air C-Version)
- 17 Exhaust silencer (Circulating air C-Version)

PRODUCT DESCRIPTION

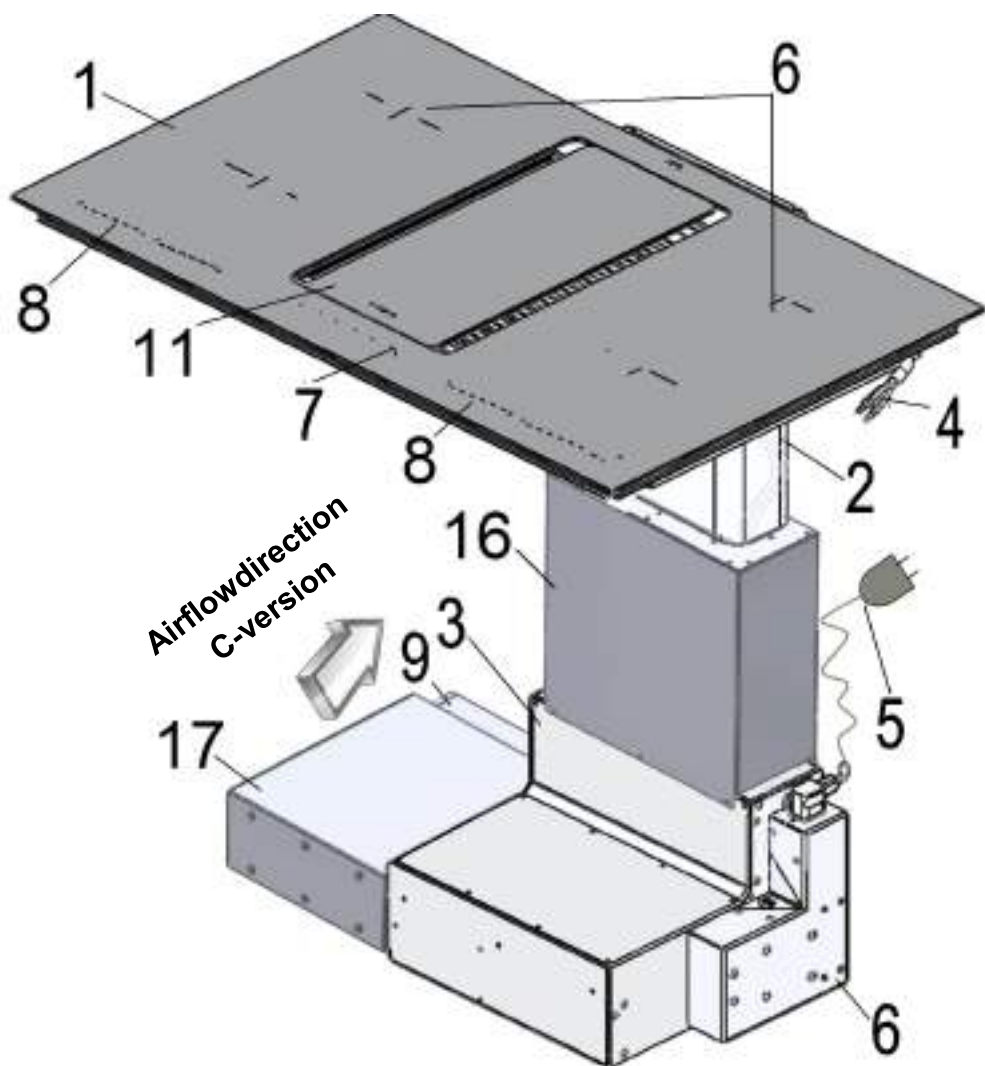

PRODUCT DESCRIPTION

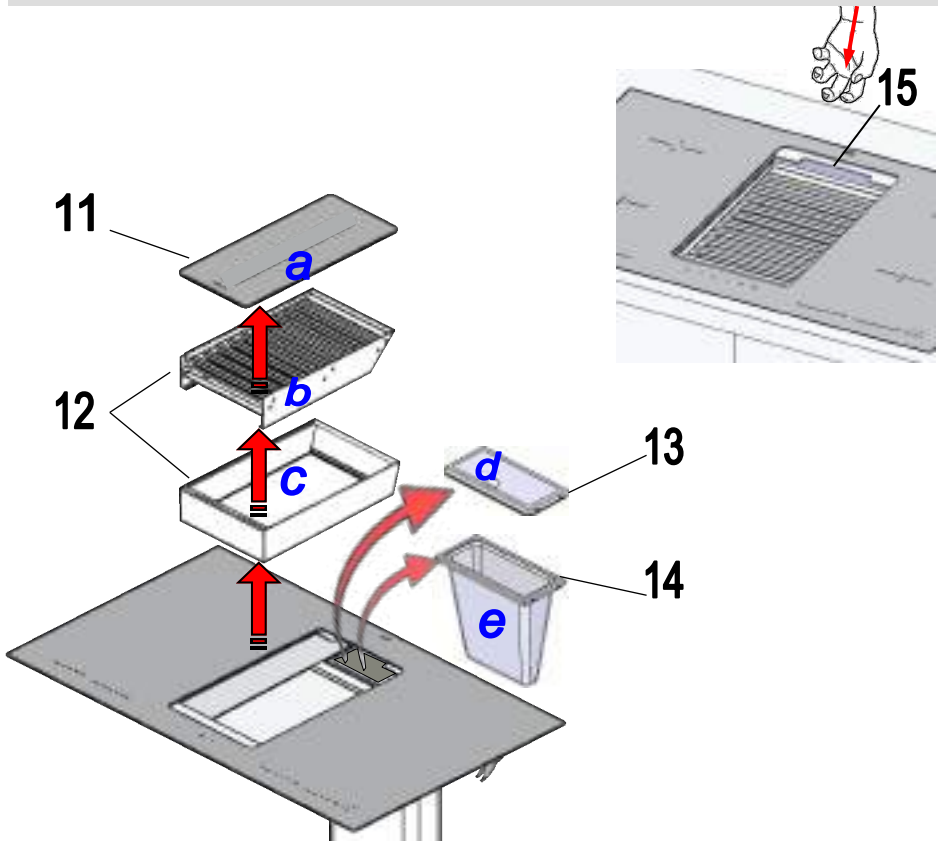

Removing **a - b - c - d - e** the filter

- 11 Safety glass, variably adjustable
- 12 Condensation filter with tray
- 13 Stainless steel grease filter
- 14 Fine dust / odour filter
- 15 Slot for removal of the filter

OPERATING INSTRUCTIONS

Operation / ventilation

The functions of the FONDA recess ventilator are controlled via a touch panel. The control panel has 3 fan power levels and an intense level, as well as a room ventilation interval cleaning function.

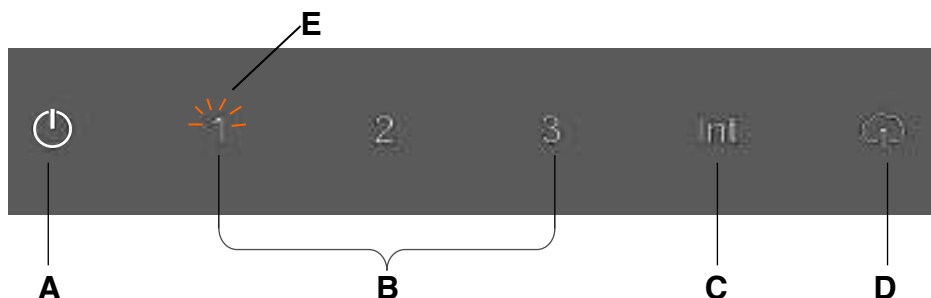

- A** Select the **ON / OFF** symbol to switch the appliance **ON**.
Fan levels **1-2-3-Int.** are ready for operation.
Appliance **ON** = symbol background lights up, press once again appliance **OFF**
- B** Press the respective power level to activate fan power levels **1-2-3** that run at a slight time delay. Press once again switches the power level off.
The active power level background is lit up.
- C** **Intense level**
Press the **Int** symbol to activate the intense level (max. fan speed).
The motor automatically switches back to the previously active level after approx. 3 min.
The active power level background is lit up.
- D** **Air cleaning interval**
Press the symbol to activate the lowest fan level for approx. 15 min / hour to help improve the room climate. The function can also be controlled when the extractor hood is **OFF**.
The active **air cleaning interval** background is lit up, press once again to deactivate this function.
- E** **Grease filter cleaning**
When the grease filter display (**E**) flashes, the stainless steel grease filter must be cleaned. After cleaning the filter, insert it again and reset the grease filter display by performing a reset. To do this, press and hold symbol "**A**" for at least 3 seconds, symbol "**1**" stops flashing. The hood must be in "**ON**" mode in order to reset the grease filter display. The grease filter display is activated after a maximum of 40 operating hours.

Hob operation

Please read the separate hob instructions.

REPLACING THE FILTER

Remove filter "Condensation filter".



Function:

Water and some of the dirt particles are separated from the cooking fumes at the fins of the condensation filter by means of the cyclone effect and condensation. Attention: the condensation filter may heat up after a long cooking!

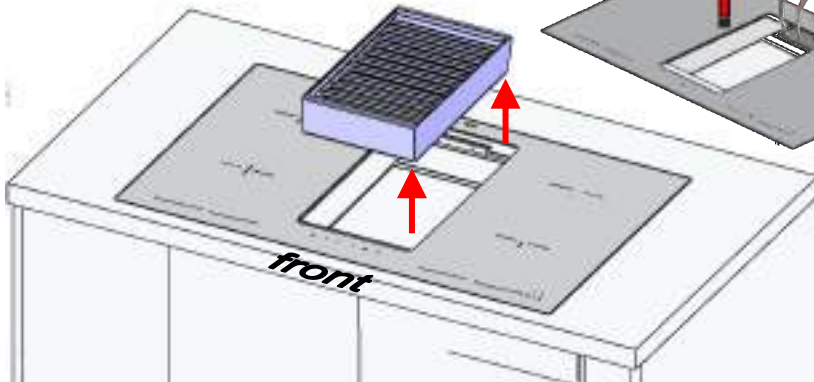
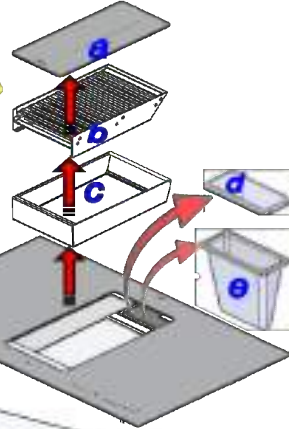

Cleaning condensation filter :

After completion of the cooking process or if necessary during the cooking process, the separated amount of water must be observed. To do this, divide the condensation filter, dump the condensate in the sink and wipe it out.

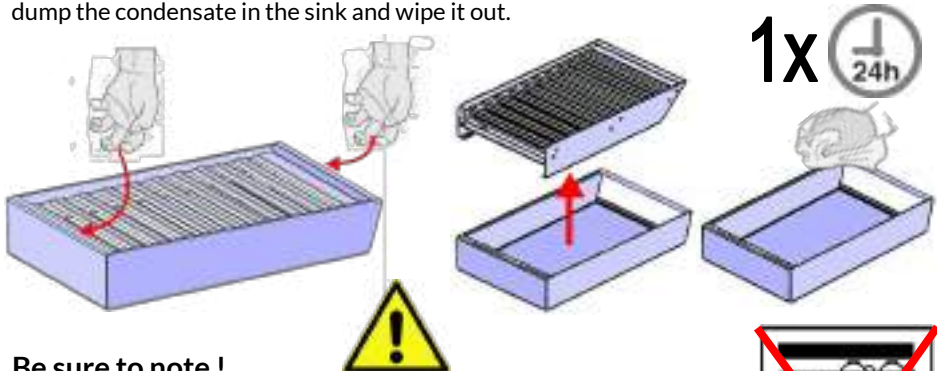

Be sure to note !

The lamellar pack and filter pan " **cannot** " be cleaned in the dishwasher. The manufacturer does not guarantee any discoloration or peeling of the coating due to the use of aggressive detergents .

Attention: Do not clean the filter in a commercial dishwasher. Cleaning with aggressive cleaning agents such as petrol, acetone, trichloroethylene, etc. can cause damage !

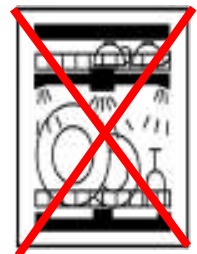

REPLACING THE FILTER

Remove filter "*Stainless steel grease filter*".



Stainless steel grease filter :

This filter separates grease particles from the cooking vapours because of its close-knit filter mesh.

Risk of fire! Grease residues decrease the extractor's performance and increase the risk of fire. Regularly clean the magnetic tape filter to prevent a risk of fire. The stainless steel mesh filter must be cleaned at least once a fortnight.

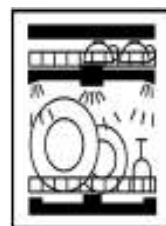
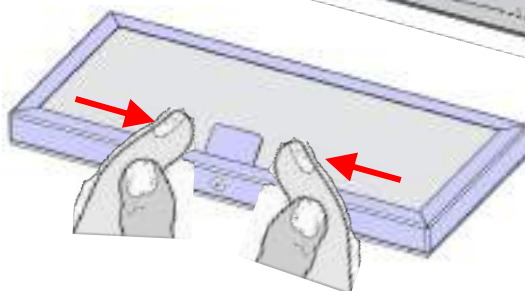
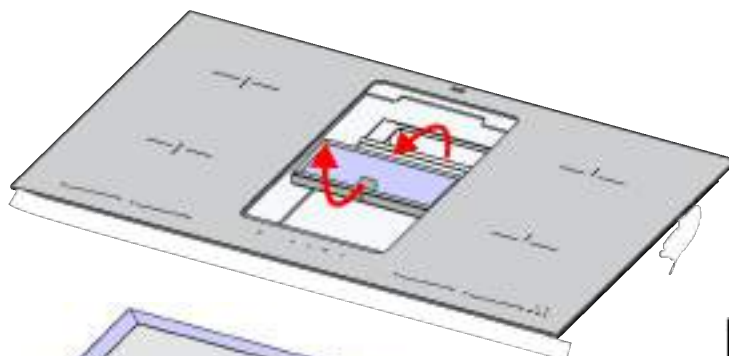

max. 55°C

Cleaning stainless steel grease filter:

The metal filter is best cleaned in the dishwasher or using a gentle dishwasher detergent which is suitable for aluminium. The manufacturer does not assume any guarantee for possible discolorations caused by the use of aggressive detergents. Temperatures above 55 degrees should be avoided in any case.

Attention: Do not use multi-phase cleaners. Do not clean the filter in a commercial dishwasher. Cleaning with aggressive cleaning agents such as petrol, acetone, trichloroethylene etc. will destroy the metal filters!

Please note: Due to a galvanic reaction occurring during the rinsing process, magnetic tape filters must not be washed simultaneously with silver cutlery or silver dishes. Unfortunately, there is no right to complain if this fact is not taken into account.

After cleaning, the installation is carried out in reverse order. We recommend switching on the fan at level 3!

REPLACING THE FILTER

Remove the filter “*fine dust / odour filter*” (optional)



Fine dust / odour filter

No cleaning is necessary because these are disposable filters. However, the filters should be replaced at least every 4 months. Or if necessary, if the cleaning performance of the filter deteriorates (noticeable by the fact that the hood no longer operates at full power or the room air quality deteriorates). The replacement interval depends on the use of the extractor; the filter must be replaced more often when it is used intensively.

Function:

The fine dust / odour filter combines fine dust filter technology with the activated carbon / odour filter. This filters fine dust particles, house dust, animal hair but also plant pollen or spores out of the cooking vapours and room air. In addition, the cooking odours are also largely neutralised through the combination with the activated carbon filter.

Removing the filter:

To do this, reach into the recess extractor and grip the stainless steel frame of the fine dust / odour filter and pull it forward. Make sure that the fan is switched off.

Remove the stainless steel frame of the fine dust / odour filter sideways, dispose of the old filter and push a new fine dust / odour filter into the stainless steel frame.

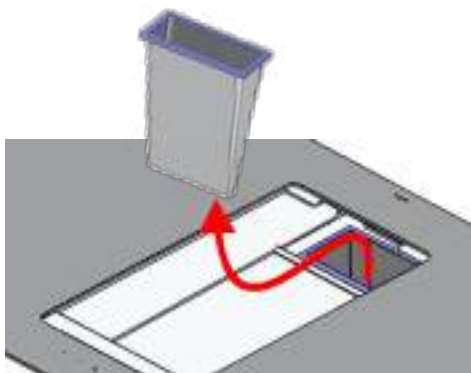

Fine dust / odour filters are disposable filters and cannot be cleaned or regenerated! Dispose of the full fine dust / odour filter at least every 4 months or when the room air quality deteriorates.

Clogged filter pores reduce the suction power of the fine dust / odour filter.

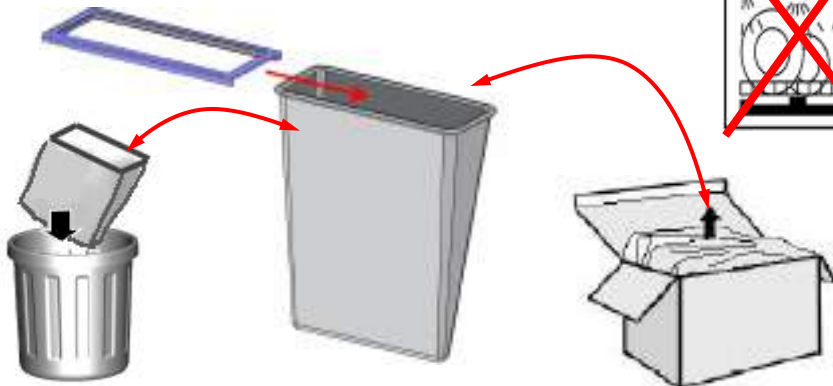
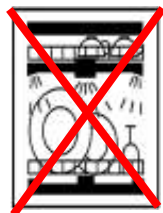

REPLACING THE FILTER

Filter installation "fine dust / odour filter" (optional)

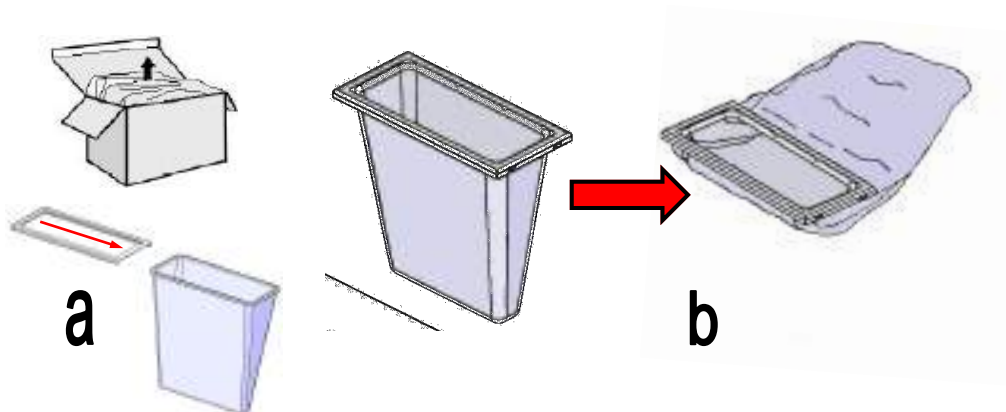

Installing the filter, preparing the activated carbon filter:

- a Push the new fine dust / odour filter into the stainless steel frame (see figure).
- b Now fold the fine dust / odour filter (see figure).
- c When folding the seams with your fingers, press them inwards so that nothing protrudes!

X = largest slide-in opening

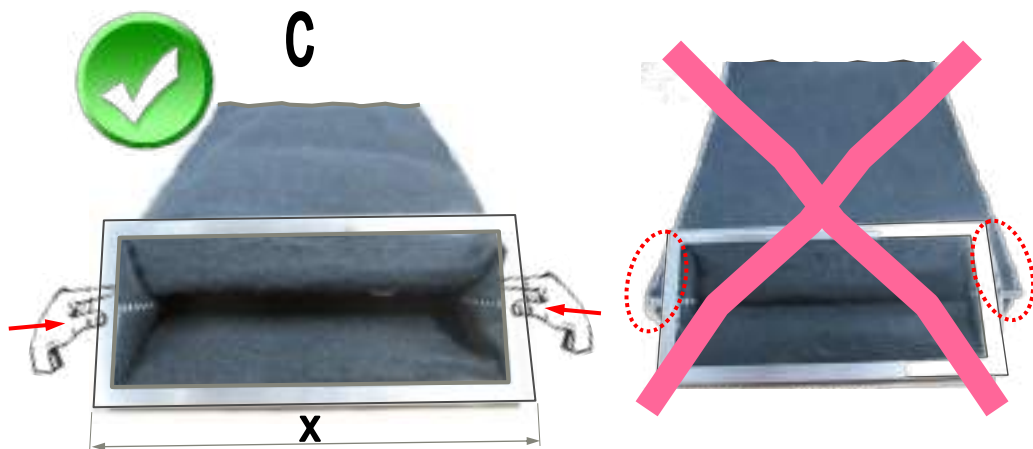

REPLACING THE FILTER

Installing the filter “*fine dust / odour filter*” (optional)

Installing the filter:

To do this, first switch on the fan to level 3 (so that the fine dust / odour filter can unfold during installation). Now fold the fine dust / odour filter (see image) and place it in the recess extractor. Now push this slowly backwards until it protrudes into the extractor shaft and is sucked in. The fine dust / odour filter is in the correct position when it sits flush in the filter holder.

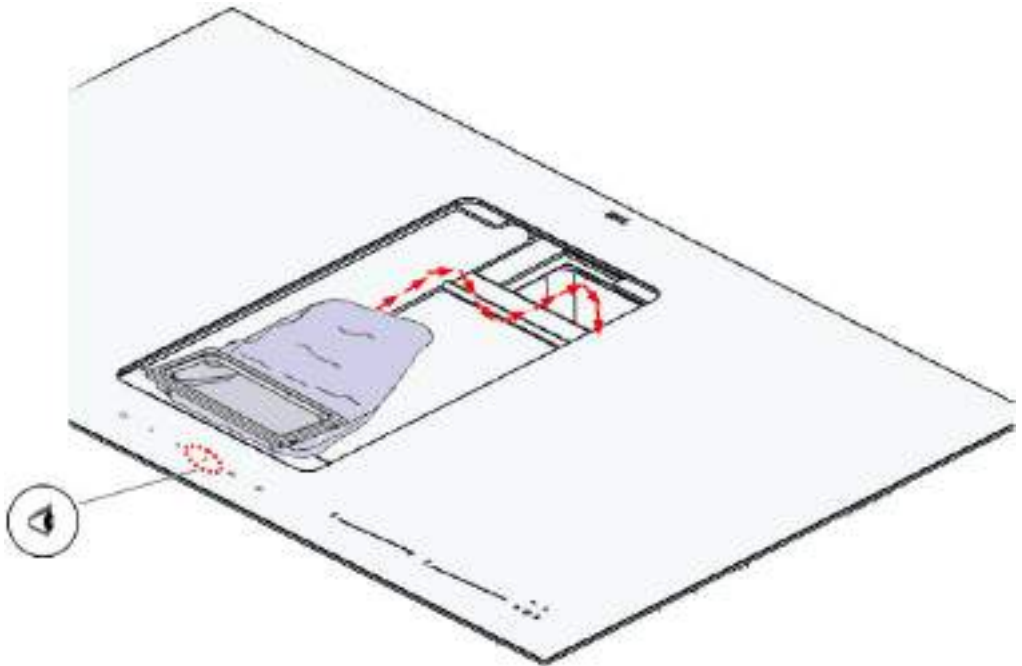

USER INFORMATION

User information: “*Optimum extraction*”

Tip: Place a cooking spoon between the lid and saucepan when using pans with a height of more than 15 cm to ensure the effective removal of steam.



If the glass is dirty, clean it only with a mild glass cleaner and a very soft cloth.



Cooking on the left side
= push the glass to the right.



Cooking on the right side
= push the glass to the left.

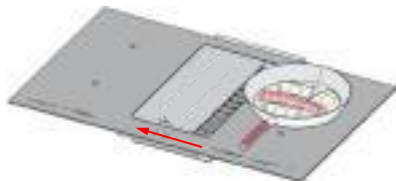

Cooking on both sides
= push the glass to the middle.

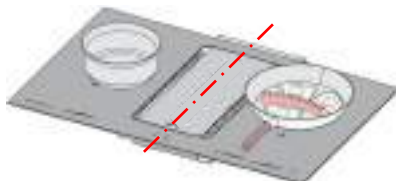

Caution: Please wipe out any liquid that boils over or spills into the recess ventilator immediately so that the fan motor is not damaged !

USER INFORMATION

Risk of burns !

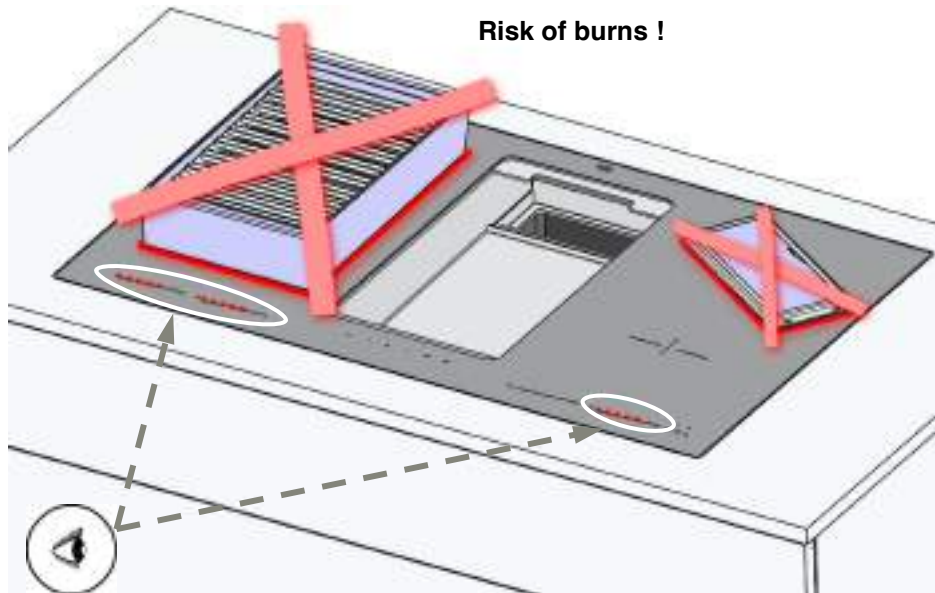

Caution: Do not place the filter on the hob if it is switched on ! Risk of burns !

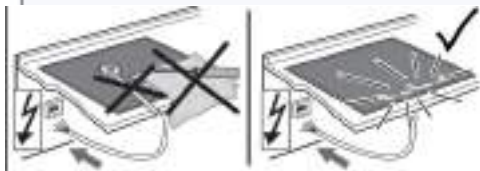
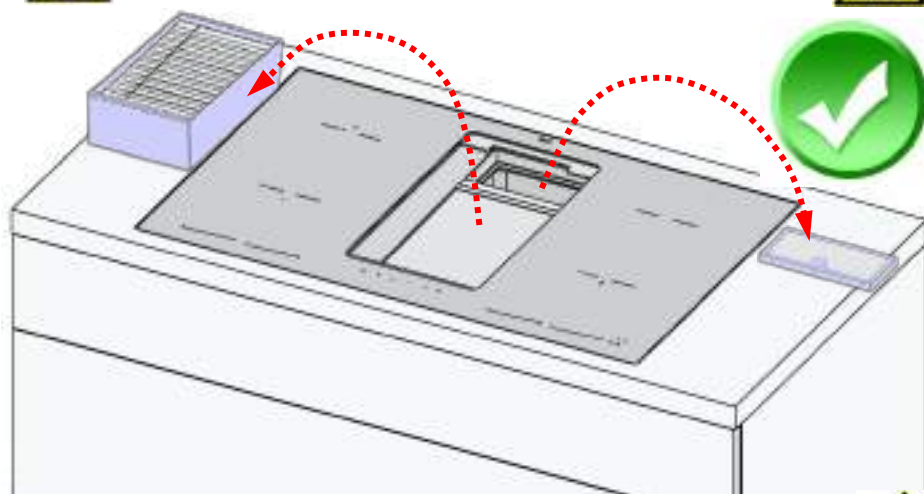

Caution: Do not place any foreign objects on the hob ! Risk of burns !

CLEANING AND CARE

Cleaning the surfaces

Danger due to electric shock! Disconnect the extractor hood from the power supply by pulling the plug out of the socket or by switching off the fuse. When cleaning, make sure that no water penetrates the device. Regular cleaning of the surface saves laborious removal of stubborn contamination. Only use conventional detergents or universal cleaning agents suitable for cleaning stainless steel/aluminium. Never use abrasive cleaning agents or steel wool. After cleaning the hood, treat the stainless steel surfaces with a stainless steel care product. Painted surfaces should only be cleaned using a mild detergent solution and a very soft cloth. Only use a soft damp cloth to clean the operating panel. On hoods fitted with a panel below the filter (edge extraction), grease deposits occur at the edge of the panel. These deposits occur for physical reasons and are not due to a malfunction of the hood. Please clean the panel underneath the filter regularly to prevent the formation of stubborn residues.

Cleaning and care instructions

When cleaning the grease filters, also remove any grease deposits from the accessible housing components. This will prevent a fire hazard and maintain an optimum range of functions. Use hot soapy water or a mild window cleaning agent to clean the hood. Do not scratch off baked-on deposits. Soften them using a damp cloth. Do not use abrasive agents or scouring pads. Note: Do not use alcohol (spirits) on plastic surfaces, as dull spots may result.

Caution: Ventilate the kitchen sufficiently, no open flame.

Only clean the operating panel with a soft damp cloth (mild detergent solution). Do not use stainless steel cleaners for the sliding switch/pressure switch.

Stainless steel surfaces

Use a mild and non-abrasive stainless steel cleaning agent. Do not clean stainless steel surfaces with abrasive scouring pads or with cleaning agents containing sand, soda, acid or chloride! Clean in direction of polish only.

Aluminium, varnished and plastic surfaces

Use a soft micro fibre cloth. Do not use dry cloths. Use a mild window-cleaning agent. Do not use aggressive cleaning agents or agents containing acid or lye! Do not use scouring agents.

Glass surfaces:

The glass front installed on the extractor hood must only be cleaned with a mild glass cleaner and a very soft cloth. Please do not under any circumstances clean the middle glass plate in the dishwasher - risk of matting!



FAULTS / MAINTENANCE

Faults:

Please contact our customer services immediately in the following cases:

- If the extractor hood generates unusual noises and you are unable to detect any faults after checking the exhaust air line.
- If you discover, for example, by hearing strange noises, that the motor is faulty or defective.
- If the switches / controller are not working properly.
- The motor is not running despite there being electric voltage.
- Control panel is not working properly.
- The motor generates strong vibrations or an imbalance in operation.
- The power supply cable gets unusually hot.
- A smell of burning is coming from the appliance.

The hood must not be used any longer if any of the above-mentioned issues occur!

Do not attempt to repair the appliance yourself.

Please note that filters are wear parts and are subject to certain maintenance intervals.

CAUTION: Always disconnect the extractor from the power supply before working on it!

Customer Service:

- **Netherlands, Belgium, Luxembourg:** call the number +31 038 385 1850 or send an e-mail to service@alluance.nl;

Please be sure to indicate the type of your cooker hood and its AB number. You will find this information on the nameplate.

WARNING



If an abnormality occurs (such as a smell of burning), switch off the recess ventilator immediately and disconnect it from the power supply!

• **Continued operation under such circumstances may result in faults, an electric shock or a fire.**

ENVIRONMENTAL INFORMATION

Disposal



Packaging

The packaging for the extractor hood is recyclable. Cardboard and polyethylene film (PE) are used as packaging materials. These materials must be disposed of in an environmentally compatible manner in accordance with local regulations.

Extractor hood

Your local authority will also be happy to advise you on the environmentally sound disposal of old household appliances.

Environmental information

All models manufactured by Kosmo srl are identified in accordance with European Directive 2002/96/EC on waste electrical and electronic equipment (WEEE). This directive specifies the framework for the EU-wide return and disposal of used appliances. Please ask your dealer for information about current disposal methods. We reserve the right to make technical changes.

Technical Data

Connection to mains:

1N 220-240 V AC 50/60 Hz, max. 169 Watt (performance data related to ventilation only!)

Product codes

DFO80A120
DFO80A121
DFO80A140
DFO80A141
DFO80B120
DFO80B121
DFO80B140
DFO80B141
DFO80C120
DFO80C121
DFO80C140
DFO80C141

DFO83A120
DFO83A121
DFO83A140
DFO83A141
DFO83B120
DFO83B121
DFO83B140
DFO83B141
DFO83C120
DFO83C121
DFO83C140
DFO83C141

DFO90A120
DFO90A121
DFO90A140
DFO90A141
DFO90B120
DFO90B121
DFO90B140
DFO90B141
DFO90C120
DFO90C121
DFO90C140
DFO90C141

LABEL HERE

OPERA

OPERA Hausgeräte GmbH

Unterm Wolfsberg 9/9a
75177, Pforzheim - Germany
+49 (0)7231-1677265
info@operahsg.de



operahsg.com

LIB30930
REV. 02 - 09/22